

P.K.	0+000	0+500	1+000	1+500	2+000	2+500	3+000	3+500	4+000	4+500	5+000	5+500	6+000	6+500	7+000	7+500															
COTA DE RASANTE	19.21	20.56	20.89	19.22	17.29	15.36	13.43	11.50	9.58	7.65	6.41	8.04	10.54	13.04	15.54	17.99	18.15	15.75	13.25	10.75	8.25	6.84	7.18	7.68	8.18	8.68	9.18	9.68	10.18	10.68	11.18
COTA DE TERRENO	19.21	20.53	20.33	18.64	13.76	11.38	15.43	8.73	5.78	3.78	4.82	6.38	10.00	26.42	40.00	58.40	46.42	22.55	7.93	3.49	1.28	5.90	10.01	7.71	3.49	12.71	10.33	9.71	8.23	8.54	8.07
COTA ROJA DESMONTE					2.00									13.39	24.46	40.41	28.27	6.80					2.84	0.03		4.03	1.15	0.04			
COTA ROJA TERRAPLEN	0.00	0.03	0.56	0.58	3.53	3.98		2.78	3.79	3.87	1.58	1.66	0.54						5.32	7.26	6.97	0.94		4.68				1.95	2.14	3.11	
DIAGRAMA DE CURVATURAS	RECTA	A=281 R=525		RECTA		A=281		RECTA		A=904 R=3550		A=904		RECTA		A=904 R=3550		RECTA													
	0+000.000	0+330.120	0+480.120	1+850.377	2+000.377	4+132.032	4+362.032	4+915.060	5+145.060	5+375.060	5+613.584																				

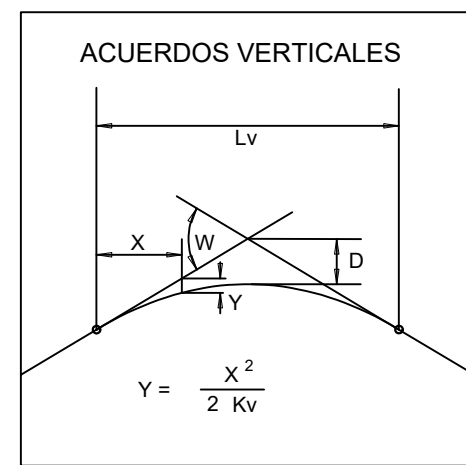

P.K.
COTA DE RASANTE
COTA DE TERRENO
COTA ROJA DESMONTE
COTA ROJA TERRAPLÉN
DIAGRAMA DE CURVATURAS

TÍTULO:
ESTUDIO DE ALTERNATIVAS Y VIABILIDAD DEL TRAMO BILBAO - SANTANDER DEL CORREDOR CANTÁBRICO MEDITERRÁNEO

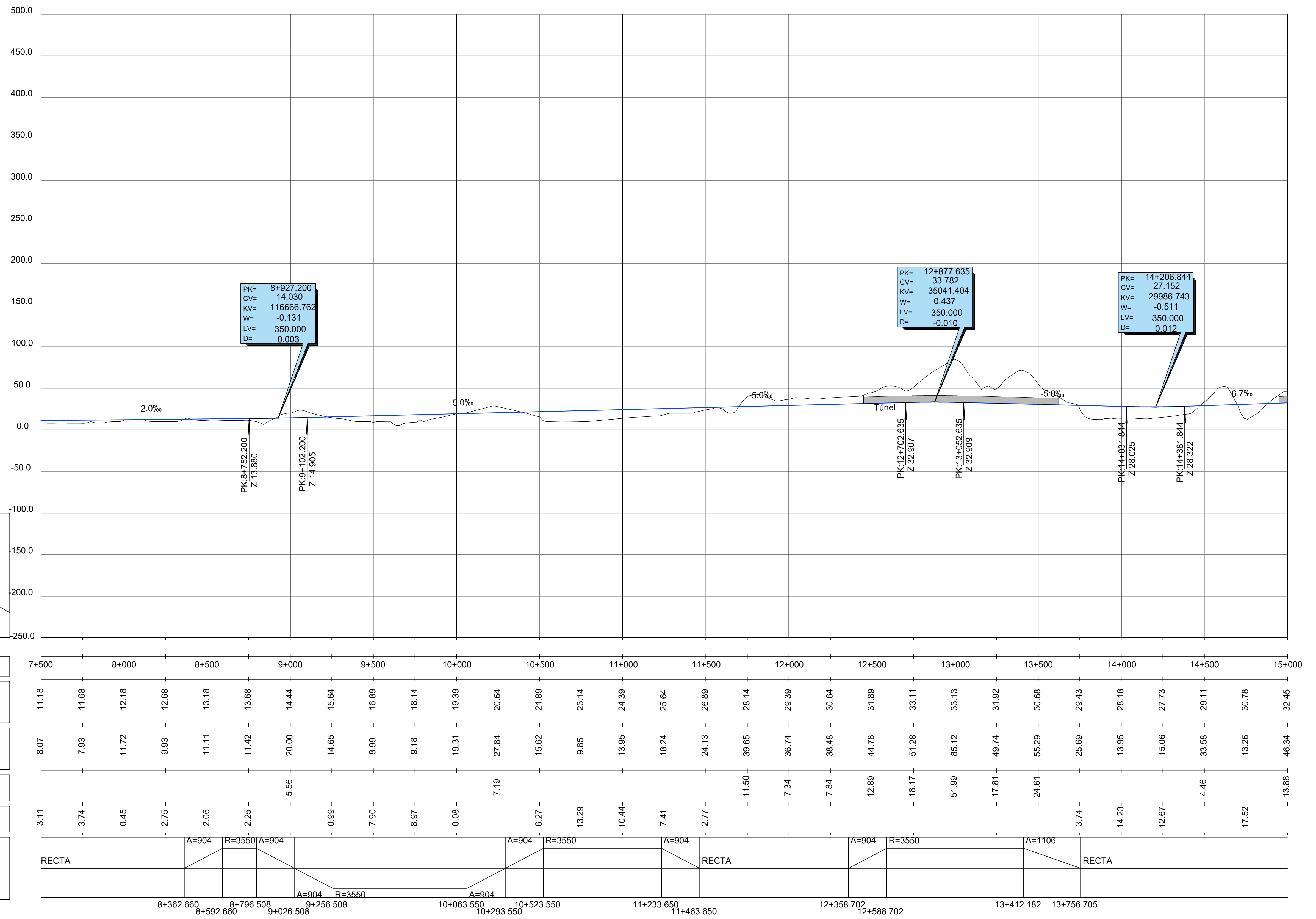

ESCALA ORIGINAL:
1:12.500
Numérica: DIN A-1
Gráfica: 0 250 500m

FECHA:
SEPTIEMBRE 2021

Nº DE PLANO:
2.4.5
HOJA 02 DE 10

TÍTULO DEL PLANO:
PERFILES LONGITUDINALES ALTERNATIVA C.1 TRAFICO MIXTO



SECRETARÍA DE ESTADO DE TRANSPORTES, MOVILIDAD Y AGENDA URBANA
SECRETARÍA GENERAL DE INFRAESTRUCTURAS
DIRECCIÓN GENERAL DE PLANIFICACIÓN Y EVALUACIÓN DE LA RED FERROVIARIA

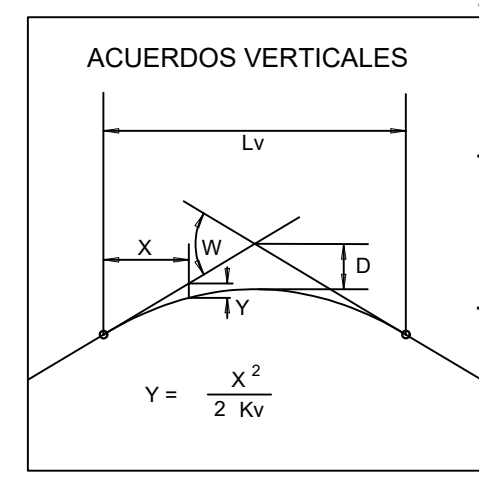
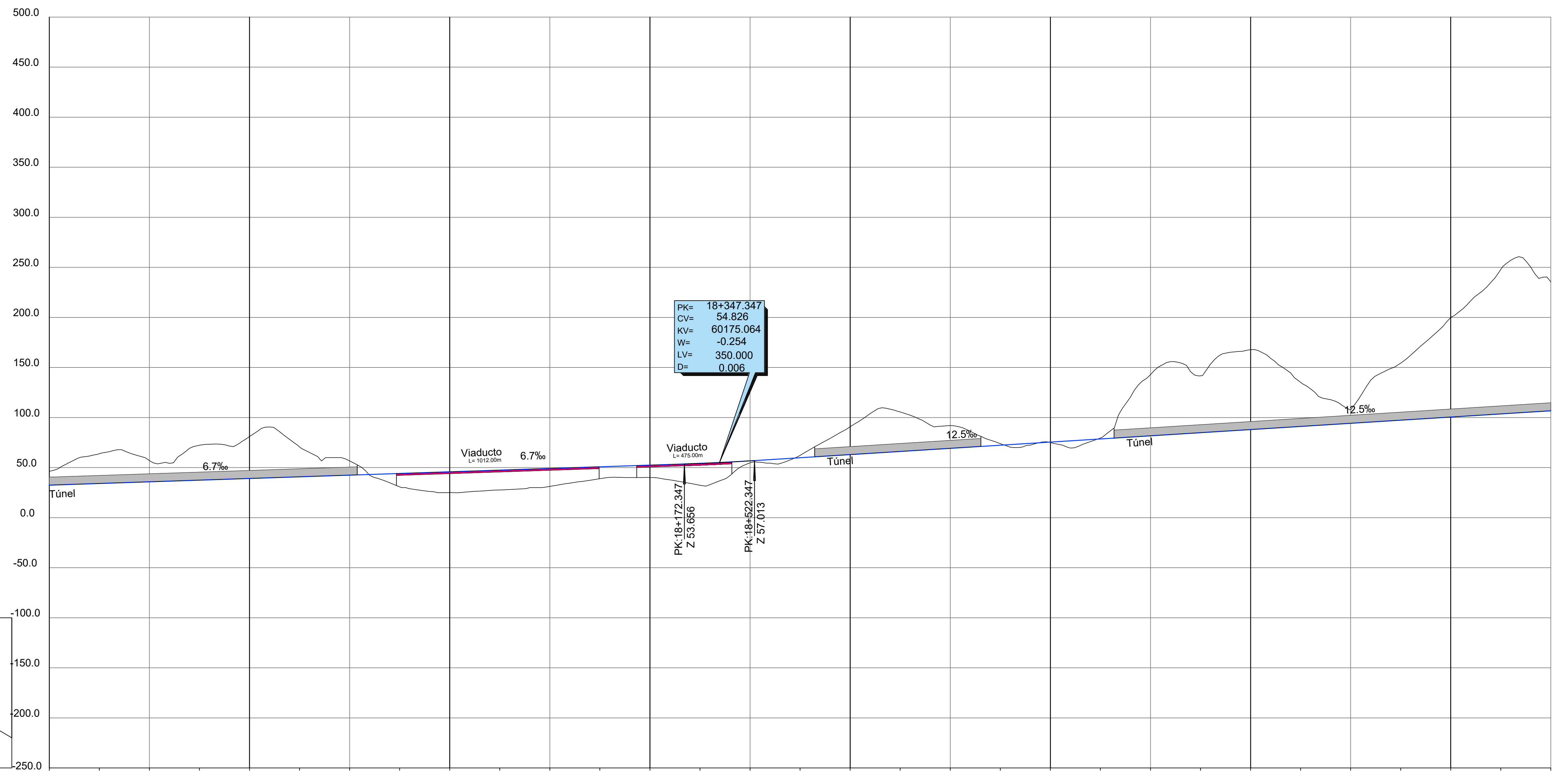

P.K.	15+000	15+500	16+000	16+500	17+000	17+500	18+000	18+500	19+000	19+500	20+000	20+500	21+000	21+500	22+000	22+500																
COTA DE RASANTE	32.45	34.12	35.79	37.47	39.14	40.81	42.48	44.15	45.82	47.49	49.16	50.83	52.50	54.23	56.74	59.86	62.98	66.11	69.23	72.36	75.48	78.61	81.73	84.86	87.98	91.11	94.23	97.36	100.48	103.61	106.73	
COTA DE TERRENO	46.34	63.87	56.99	72.29	80.98	70.65	56.68	30.77	24.99	27.64	31.15	38.94	40.05	32.37	54.74	62.22	90.88	105.52	92.00	73.95	74.93	79.56	142.78	141.68	167.79	135.15	107.60	154.37	200.00	247.92	235.48	
COTA ROJA DESMONTE	13.88	29.75	21.20	34.83	41.85	29.85	14.20									2.37	27.90	39.41	22.77	1.59		0.95	61.04	56.82	79.81	44.04	13.37	57.01	99.51	144.31	128.75	
COTA ROJA TERRAPLÉN								13.38	20.83	19.86	18.01	11.90	12.45	21.86	2.00							0.55										
DIAGRAMA DE CURVATURAS	RECTA																A=1082 R=3550		A=1082 R=3550		A=1082 R=3550		A=1082									
																	17+454.660 17+784.660		20+022.394 20+352.394		20+682.394		22+249.456									

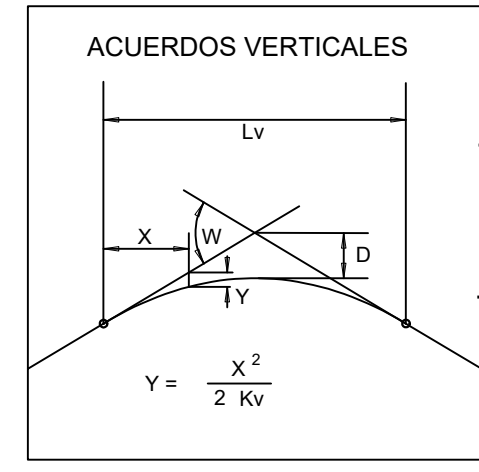
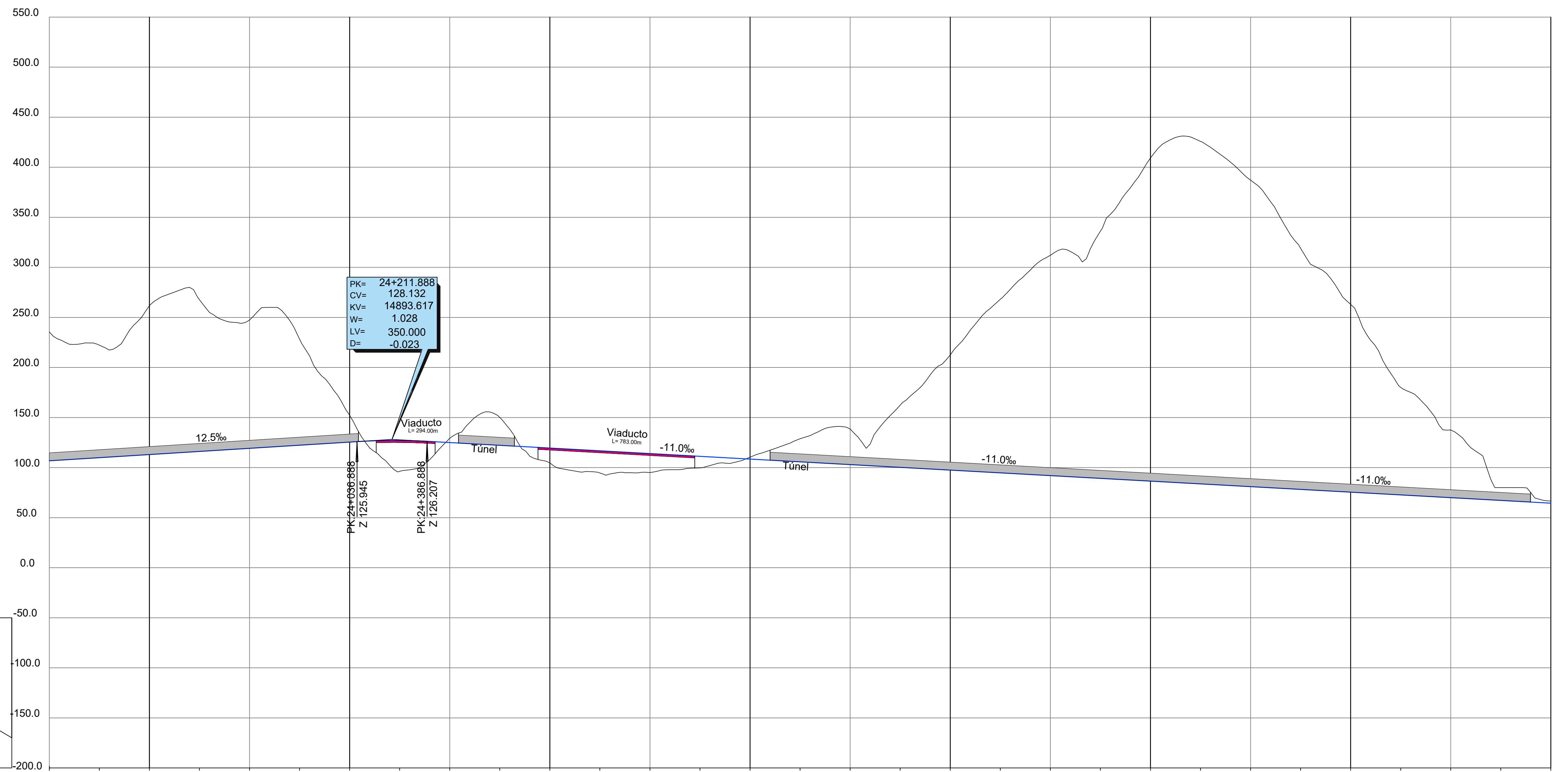

P.K.	22+500	23+000	23+500	24+000	24+500	25+000	25+500	26+000	26+500	27+000	27+500	28+000	28+500	29+000	29+500	30+000																
COTA DE RASANTE	106.73	109.86	112.98	116.11	119.23	122.36	125.48	127.08	124.96	122.21	119.46	116.71	113.96	111.21	108.46	105.71	102.96	100.21	97.46	94.71	91.96	89.21	86.46	83.71	80.96	78.21	75.46	72.71	69.96	67.21	64.46	
COTA DE TERRENO	235.48	222.29	261.79	267.73	247.27	228.35	152.24	96.22	129.28	150.11	104.78	94.66	95.08	99.68	110.36	128.74	138.48	162.39	212.51	268.01	312.13	336.12	409.37	425.89	387.09	319.10	263.13	180.15	137.63	80.00	66.55	
COTA ROJA DESMONTE	128.75	112.43	148.80	151.62	128.03	105.99	26.76	30.86	4.31	27.90	14.69	22.05	18.88	11.53	1.90	23.03	35.52	62.17	115.05	173.29	220.17	246.91	322.90	342.18	306.12	240.89	187.66	107.44	67.66	12.79	2.08	
COTA ROJA TERRAPLÉN																																
DIAGRAMA DE CURVATURAS	RECTA																	A=1082		22+579.456												

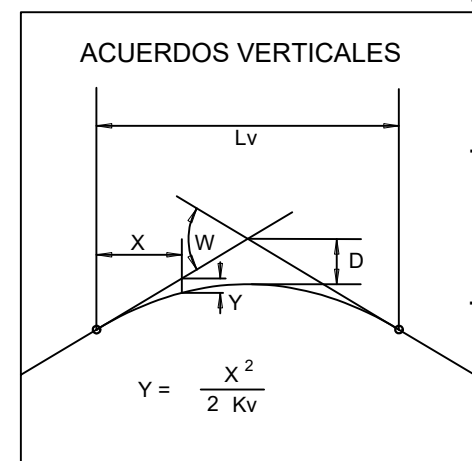
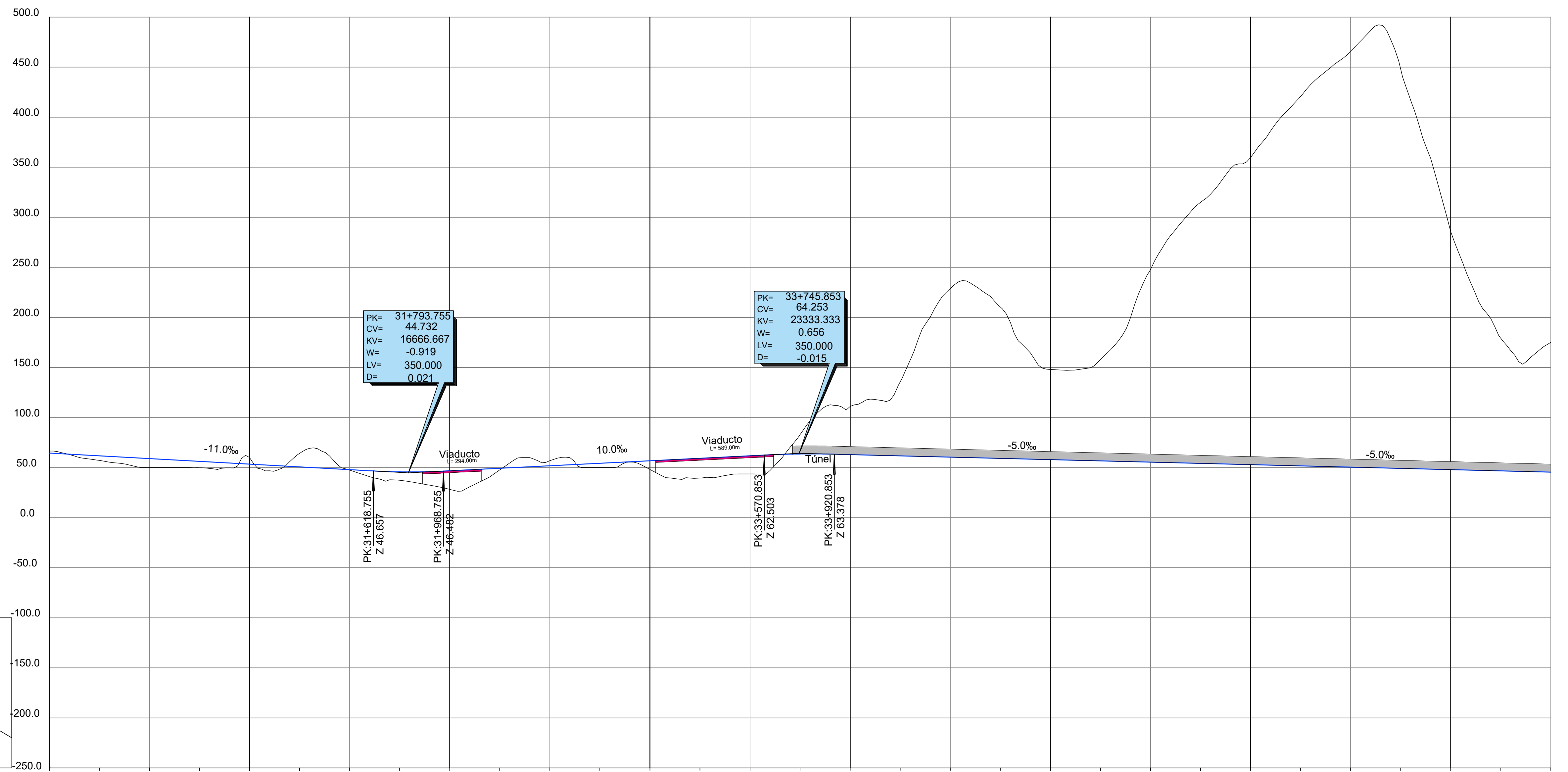

P.K.	30+000	30+500	31+000	31+500	32+000	32+500	33+000	33+500	34+000	34+500	35+000	35+500	36+000	36+500	37+000	37+500																
COTA DE RASANTE	64.46	61.71	58.96	56.21	53.46	50.71	47.96	45.73	46.79	49.29	51.79	54.29	56.79	59.29	61.79	63.61	62.98	61.73	60.48	59.23	57.98	56.73	55.48	54.23	52.98	51.73	50.48	49.23	47.98	46.73	45.48	
COTA DE TERRENO	66.55	57.16	50.00	49.81	60.04	64.19	47.52	37.28	28.25	47.66	56.92	50.00	48.14	39.53	43.63	82.90	111.04	135.63	228.86	210.44	148.01	157.78	247.69	314.93	359.70	420.77	466.03	447.92	285.67	179.08	175.05	
COTA ROJA DESMONTE	2.08				6.58	13.47				5.12						19.29	48.06	73.90	168.37	151.21	90.03	101.05	192.21	260.70	306.72	369.04	415.55	398.69	237.69	132.35	129.57	
COTA ROJA TERRAPLÉN		4.56	8.96	6.41			0.45	8.45	18.55	1.63		4.29	8.66	19.77	18.16																	
DIAGRAMA DE CURVATURAS	RECTA																															

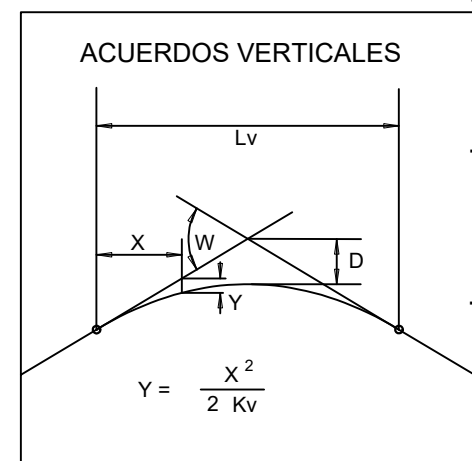
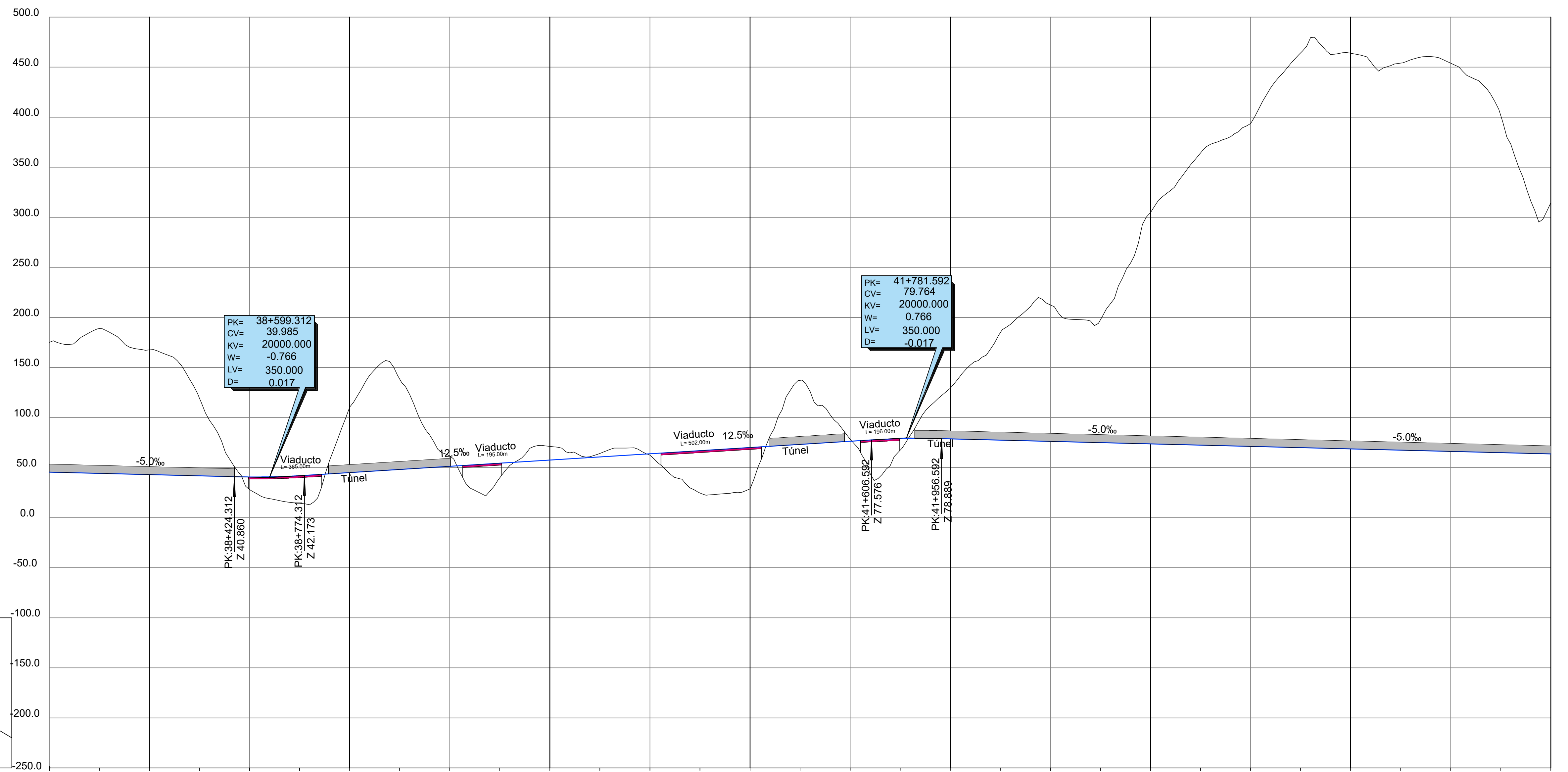

P.K.	37+500	38+000	38+500	39+000	39+500	40+000	40+500	41+000	41+500	42+000	42+500	43+000	43+500	44+000	44+500	45+000															
COTA DE RASANTE	45.48	44.23	42.98	41.73	40.63	41.88	44.99	48.12	51.24	54.37	57.49	60.62	63.74	66.87	69.99	73.12	76.24	78.85	78.67	77.42	76.17	74.92	73.67	72.42	71.17	69.92	68.67	67.42	66.17	64.92	63.67
COTA DE TERRENO	175.05	188.85	167.62	119.36	27.98	14.30	110.34	138.46	61.78	39.77	71.17	64.13	62.42	24.64	28.78	137.12	78.24	67.35	129.24	184.67	212.41	197.57	304.75	364.17	393.63	464.20	463.90	454.03	453.89	401.40	314.55
COTA ROJA DESMONTE	129.57	144.61	124.64	77.62			65.35	90.34	10.53		13.68	3.51	62.42	24.64	28.78	64.00	2.00		50.57	107.25	136.23	122.65	231.08	291.75	322.46	394.28	395.23	386.61	387.72	336.48	250.88
COTA ROJA TERRAPLÉN					12.64	27.58					14.60		1.33	42.23	41.22			11.51													
DIAGRAMA DE CURVATURAS	<p>RECTA</p> <p>A=742 R=2200 (38+362.030 to 38+612.030)</p> <p>A=742 R=2850 (41+878.899 to 42+428.899)</p>																														

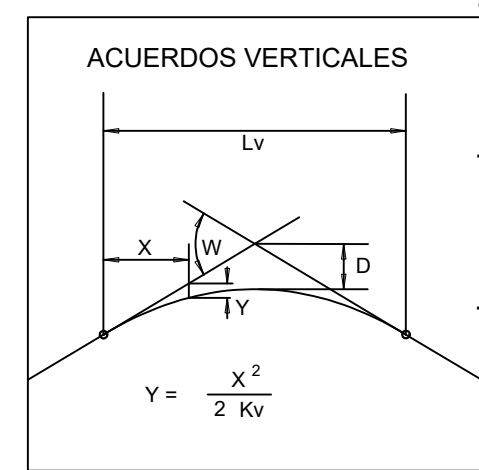
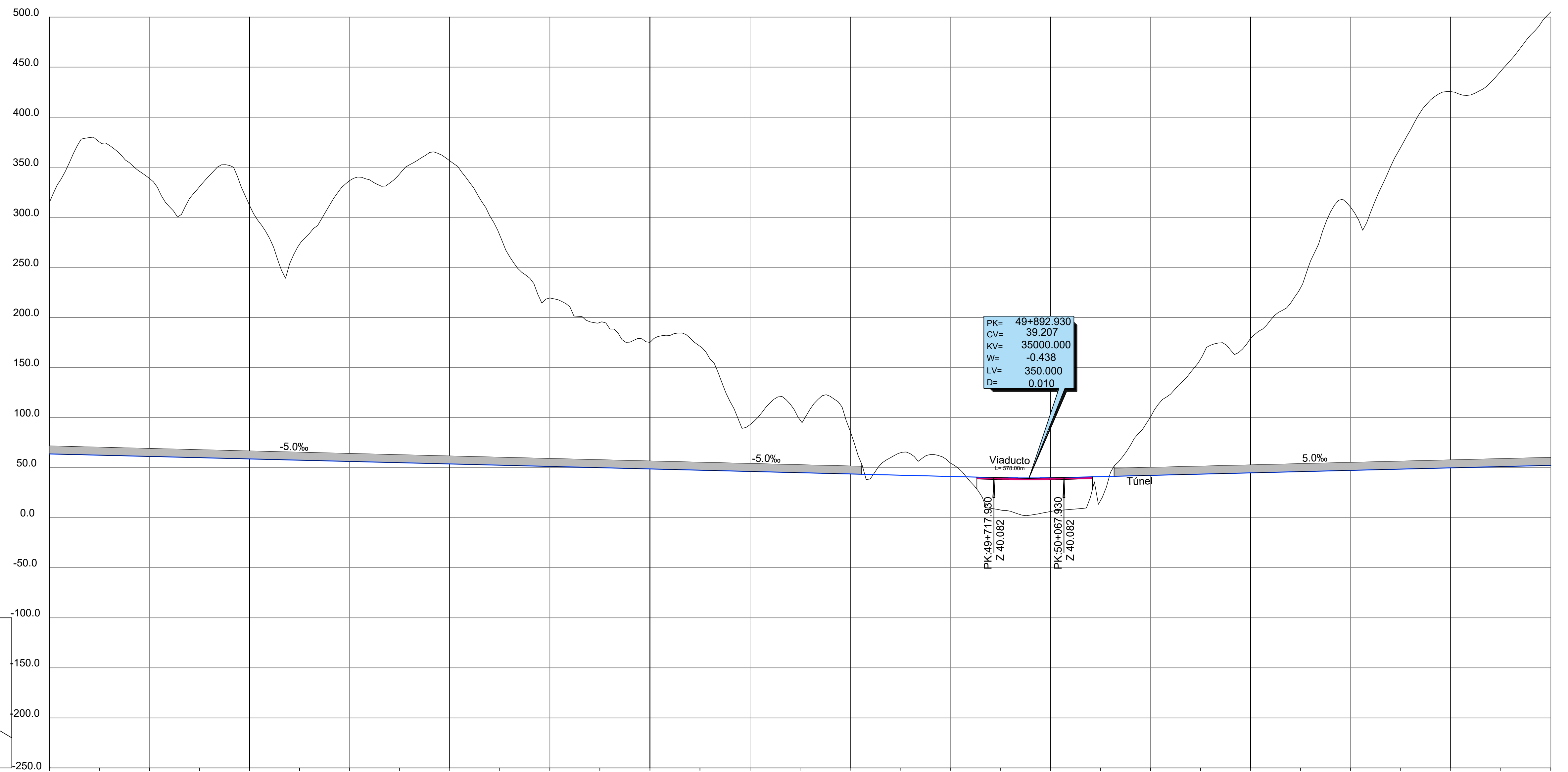

P.K.	45+000	45+500	46+000	46+500	47+000	47+500	48+000	48+500	49+000	49+500	50+000	50+500	51+000	51+500	52+000	52+500
COTA DE RASANTE	63.67	62.42	61.17	59.92	58.67	57.42	56.17	54.92	53.67	52.42	51.17	49.92	48.67	47.42	46.17	44.92
COTA DE TERRENO	314.55	375.28	338.87	330.50	311.89	273.09	336.67	343.39	356.47	282.19	219.47	194.96	174.95	171.18	92.86	97.60
COTA ROJA DESMONTE	-250.88	312.86	277.70	270.58	253.22	215.67	280.50	288.47	302.80	229.76	168.30	145.04	126.28	123.76	46.69	52.67
COTA ROJA TERRAPLÉN											32.29	33.67	24.08			
DIAGRAMA DE CURVATURAS	<p>R=2850 A=925 A=1082 R=3550 A=1082 R=3550 A=1082</p> <p>46+195.662 46+495.662 46+825.662 49+571.884 49+901.884 50+231.884 52+289.712</p>															

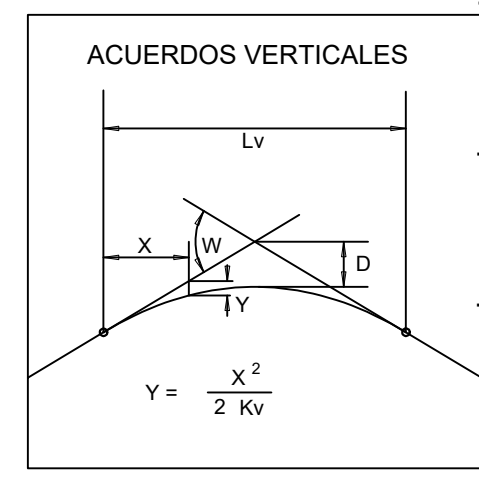
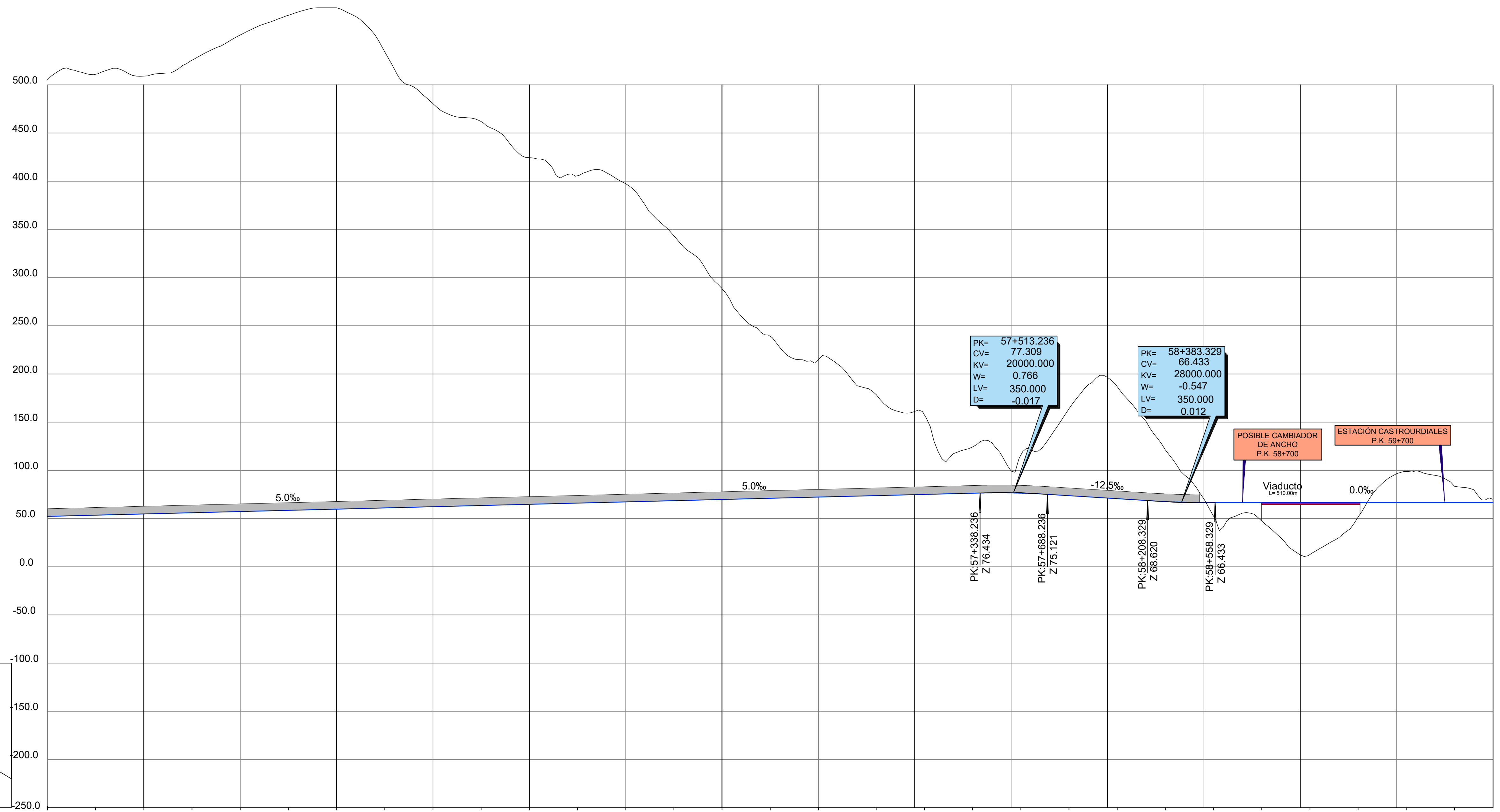

P.K.	52+500	53+000	53+500	54+000	54+500	55+000	55+500	56+000	56+500	57+000	57+500	58+000	58+500	59+000	59+500	60+000
COTA DE RASANTE	52.24	53.49	54.74	55.99	57.24	58.49	59.74	60.99	62.24	63.49	64.74	65.99	67.24	68.49	69.74	70.99
COTA DE TERRENO	505.24	510.97	509.06	525.54	551.78	572.17	580.00	534.28	480.53	461.85	424.45	405.74	397.39	343.39	288.68	239.06
COTA ROJA DESMONTE	453.00	457.47	454.32	469.55	494.53	513.68	520.26	473.29	418.28	398.36	359.71	339.75	330.15	274.90	218.94	168.06
COTA ROJA TERRAPLÉN																
DIAGRAMA DE CURVATURAS	<p>A=1082 RECTA</p> <p>A=506 R=1600</p> <p>A=506 RECTA</p> <p>A=377</p>															

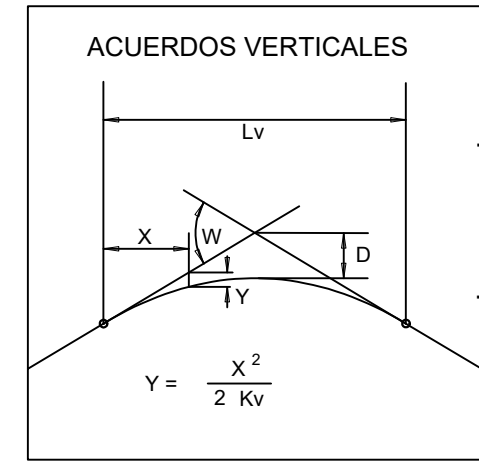
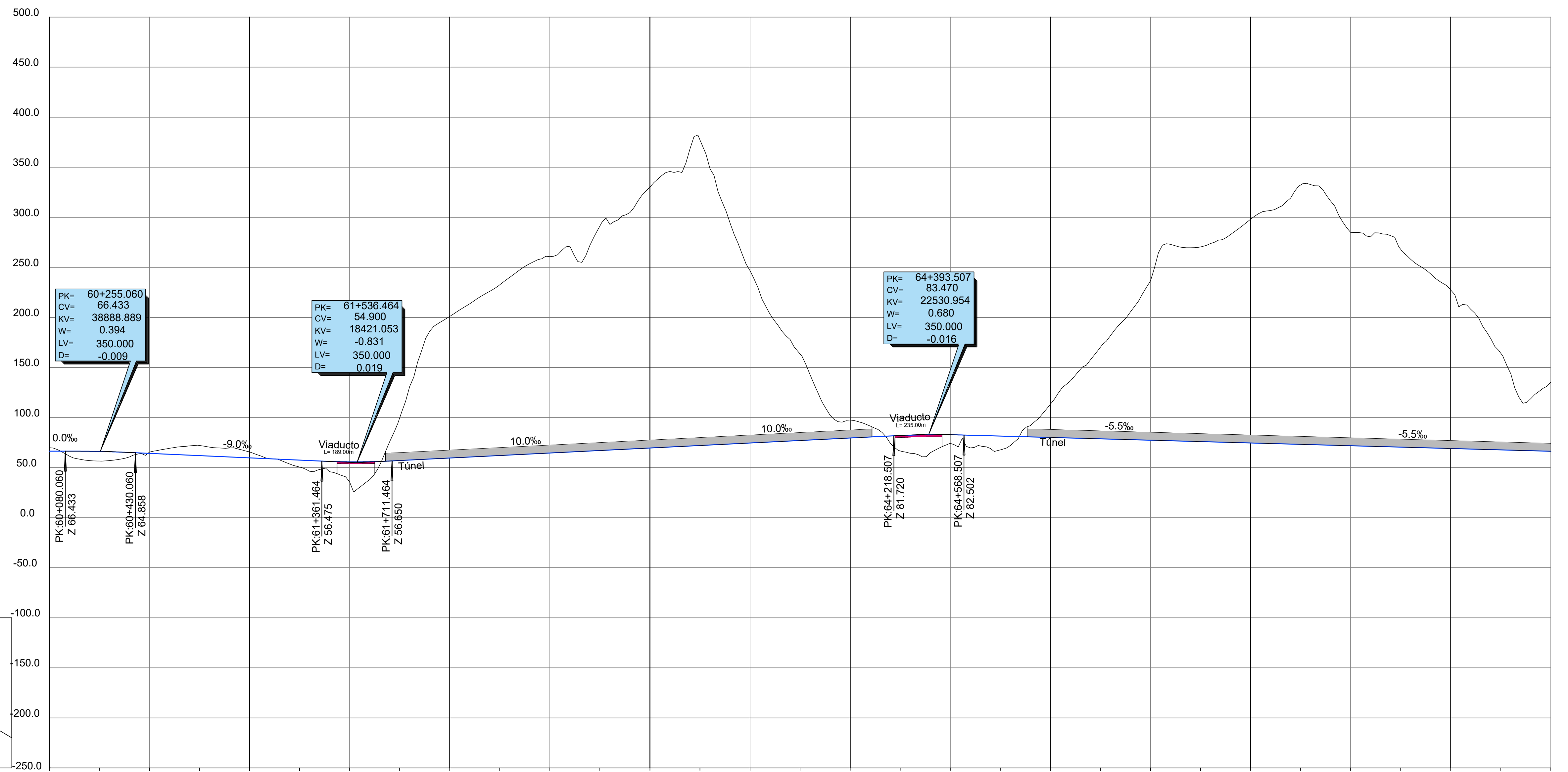

P.K.	60+000	60+500	61+000	61+500	62+000	62+500	63+000	63+500	64+000	64+500	65+000	65+500	66+000	66+500	67+000	67+500															
COTA DE RASANTE	66.43	66.06	64.23	61.98	59.73	57.48	55.75	57.04	59.54	62.04	64.54	67.04	69.54	72.04	74.54	77.04	79.54	82.01	82.78	81.50	80.11	78.73	77.35	75.96	74.58	73.20	71.81	70.43	69.05	67.66	66.28
COTA DE TERRENO	69.94	56.54	65.50	72.10	65.62	50.55	35.66	99.48	201.01	232.53	260.74	291.21	330.27	377.32	246.64	163.48	96.59	66.65	74.23	67.69	113.34	170.25	236.51	270.43	298.07	332.29	284.95	267.98	227.42	164.14	135.33
COTA ROJA DESMONTE	3.51																														
COTA ROJA TERRAPLÉN	9.53	1.27	10.12	5.89		6.93	20.08	42.45	141.48	170.50	196.21	224.17	260.74	305.29	172.11	86.45	17.05	15.36	8.55	13.81	33.23	91.52	159.16	194.47	223.49	259.09	213.14	197.55	158.37	96.48	69.06
DIAGRAMA DE CURVATURAS	<p>A=377 R=750 RECTA A=377</p> <p>60+082.180 60+508.076 60+698.076</p>															<p>A=1082 R=3550 A=1082</p> <p>66+467.645 66+797.645 67+217.691</p>															

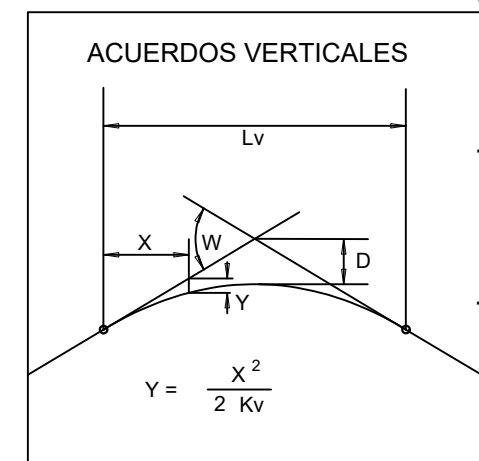
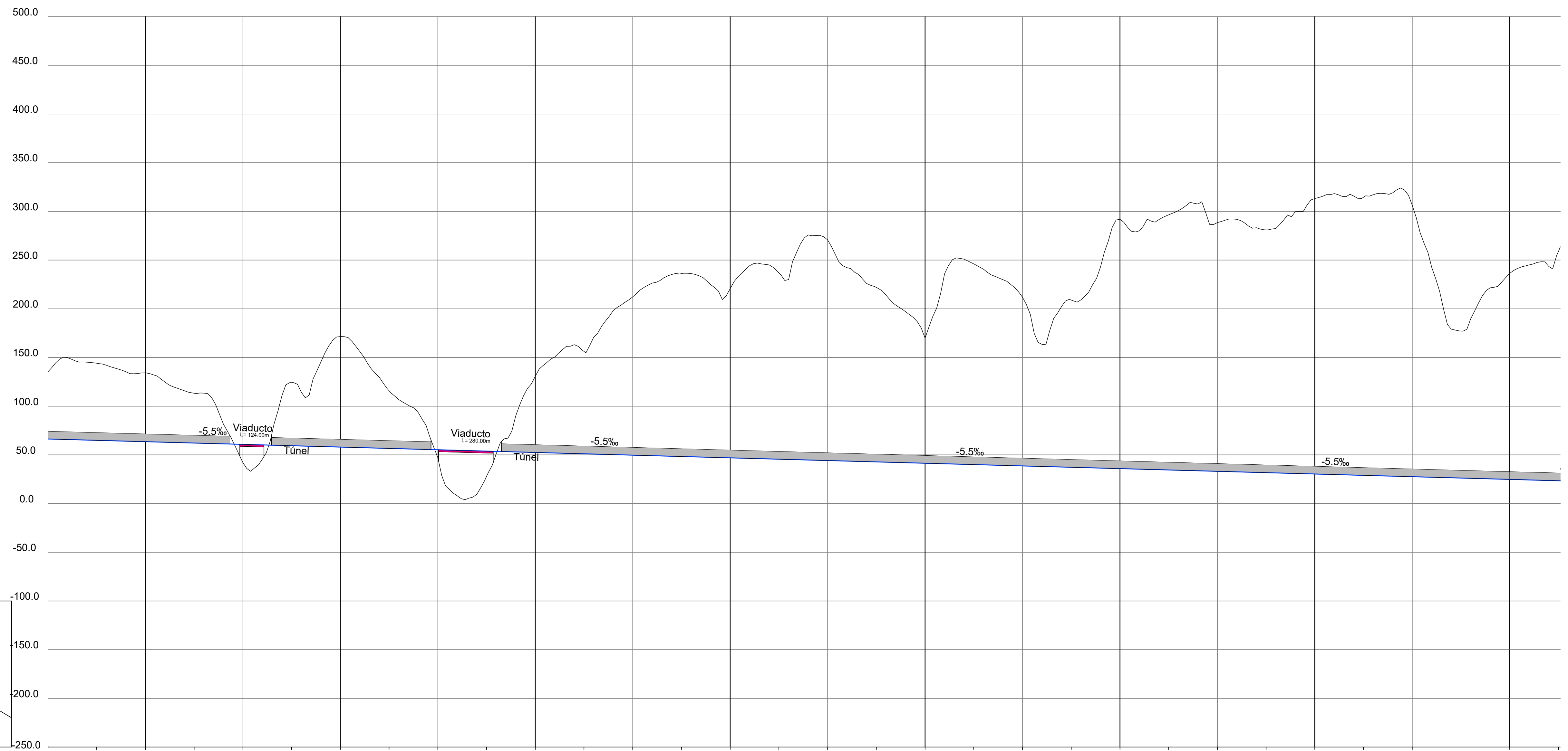

P.K.	67+500	68+000	68+500	69+000	69+500	70+000	70+500	71+000	71+500	72+000	72+500	73+000	73+500	74+000	74+500	75+000																										
COTA DE RASANTE	66.28	64.90	63.51	62.13	60.74	59.36	57.98	56.59	55.21	53.83	52.44	51.06	49.68	48.29	46.91	45.53	44.14	42.76	41.37	39.99	38.61	37.22	35.84	34.46	33.07	31.69	30.31	28.92	27.54	26.16	24.77	23.39										
COTA DE TERRENO	135.33	144.09	134.24	113.29	42.01	124.16	171.46	115.88	47.01	27.76	130.63	156.27	212.19	236.07	220.68	236.93	270.76	221.92	169.91	246.06	211.81	208.98	291.95	296.51	288.50	281.07	313.20	314.61	306.32	177.13	236.34	259.03										
COTA ROJA DESMONTE	69.06	79.20	70.73	51.16		64.80	113.48	59.28			78.18	105.21	162.52	187.78	173.77	191.41	226.62	179.16	128.54	206.07	173.20	171.76	256.11	262.05	255.43	249.38	282.89	285.68	278.78	150.98	211.57	235.64										
COTA ROJA TERRAPLÉN				18.73					8.20	26.06																																
DIAGRAMA DE CURVATURAS	AF1082																	A=1082		R=3550		A=1082		RECTA																		
	67+547.691																	69+549.898		69+879.898		71+589.994		71+919.994																		